



Florida Department of Transportation

JEB BUSH
GOVERNOR

JOSÉ ABREU
SECRETARY

Environmental Management Office
Post Office Box 607
Chipley, FL 32428
850-638-0250, Ext. 512

May 2, 2003

Mr. Duncan Cairns
Northwest Florida Water Management District
81 Water Management Drive
Havana, FL 32333-9700

RE: Mitigation Inventory

Dear Mr. Cairns:

Attached is the Mitigation Inventory for the upcoming work program.

If you have any questions or need further information, please call me at the above number or SunCom 767-1512.

Sincerely,

A handwritten signature in blue ink that reads "Frank Roberts".

Frank Roberts
Environmental Permits Coordinator

FR/rg
Attachments

cc: Joshua Boan – DOT - Tallahassee
Connie Bersok – DEP
Tommy Barfield, Bryant Paulk, Cheryl McCall – DOT

FDOT District 3 ENVIRONMENTAL IMPACT INVENTORY - FY __ 2002/2003

Work Program Item Number/Fincial Management Number	Project Description	Water Management District	Wetland Location (Include Sec., Rnge., Twship)	Name of Drainage Basin	Mitigation Date	Begin Construction Date	Florida Land Use Classification Codes (List Each Wetland Type Separately)	Impact Acres Per Each FLUCCS Type	Wetland Quality	Water Use Classification	Name of Surface Waters or Wetlands	State/Regional Designation(s)	Listed Species Affected Y/N	Permit Application Date
3110336 FIN 2179481	SR 77 from CR 2300 to Mill Creek Bridge	NWFWMD	Sect.21,16,17,8, 5,32 R-14W T-2S	St. Andrews Bay	2002/2003	07/22/2004	411 Pine Flatwoods	23.61	L	Class 3	North Bay, Fannin Bayou, Mill Creek		No	04/18/2002
3110335 FIN 2179471	SR 77 from N. Bay Bailey Bridge to CR 2300	NWFWMD	Sect:33,34,27, 28,21 R-14W T-2S	St. Andrews Bay	2002/2003	08/19/2004	411 Pine Flatwoods	7.3	L	Class 3	North Bay, Fannin Bayou		No	07/15/2002
FIN 2204423	SR 87 from North of Five Forks Road to Eglin AFB Boundary	NWFWMD	Sect: 5,6,39 R-26W T-2S	Yellow River, Blackwater River	2002/2003	05/19/2005	615 Stream & Lake Swamp	10	L	Class 3	Yellow River		No	04/15/2003
FIN 2205061	US 319 (CR 377) @ Curtis Mill Creek	NWFWMD	Sect: 35 R-3W T-5S	Ochlockonee River Watershed	2002/2003	03/24/2005	630 Wetland Forested Mixed	0.2	L	Class 3	Curtis Mill Creek		No	07/18/2002
FIN 2205071	US 319 (CR 377) @ Little Tide Creek	NWFWMD	Sect: 26 R-3W T-5S	Ochlockonee River Watershed	2002/2003	03/24/2005	630 Wetland Forested Mixed	0.17	L	Class 3	Little Tide Creek		No	07/18/2002
FIN 4062261	Roberts Landing Road @ Silver Lake Creek	NWFWMD	Sect: 3 R-4W T-5S	Ochlockonee River Watershed	2002/2003	03/25/2004	630 Wetland Forested Mixed	0.19	L	Class 3	Silver Lake Creek		No	07/18/2002
FIN 4073041	SR 8 (I-10) Over Little River & CSX RR	NWFWMD	Sect: 34 R-2-N T-3-W	Ochlockonee River Watershed	2002/2003	03/25/2004	615 Stream & Lake Swamp	0.44	L	Class 3	Little River		No	08/26/2002

WASHINGTON COUNTY
BAY COUNTY

TO
CHIPLEY

20

COURT
MARTIAL
LAKE

WHITE
WESTERN

LITTLE
ISLAND
LAKE

LITTLE
ISLAND
LAKE

LITTLE
BLUE
LAKE

MEMORIAL
LAKE

BIG
ISLAND
LAKE

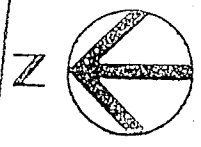

CEDAR

END PROJECT

MILL
CREEK

CREEK

77

308

VICKSBURG

BEGIN RDWY PROJ.

SOUTHPORT

2300

2324

2324

BAY
NORTH

SR 77 From CR 2300 to Mill Creek Bridge
FM No. 2179481 - WPI No. 3110336

HDR

SR 77 PD & E Study ... Section: 21,16,17,8,5,32
Range: 14W
Township: 2 South

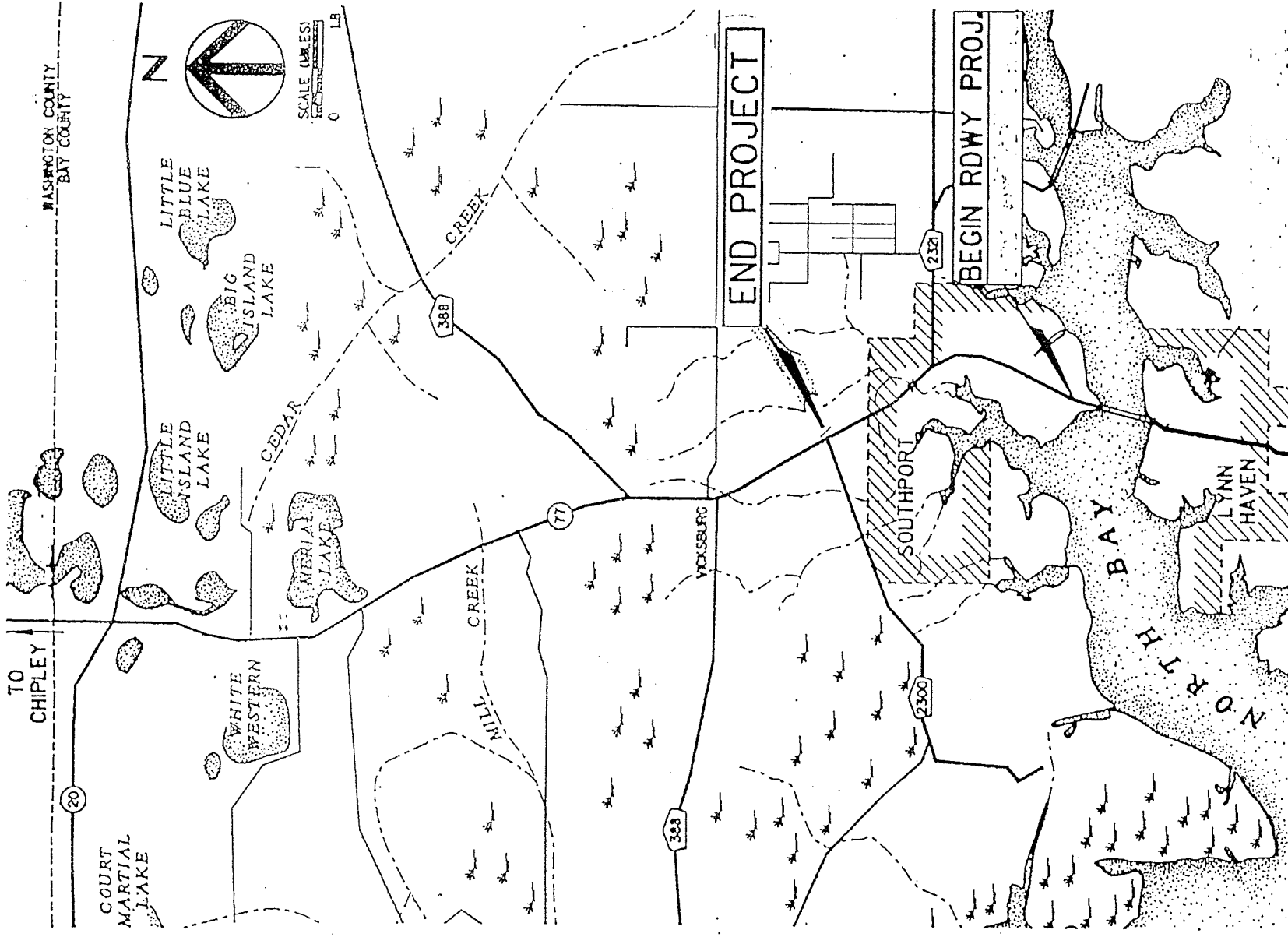

HDR

HDR Engineering, Inc.

SR 77 PD & E Study ...
 SR 77 Bailey Bridge to CR 2300
 FM No. 2179471 - WPI No. 3110335
 Section: 33,34,27,28,21
 Range: 14W
 Township: 2 South

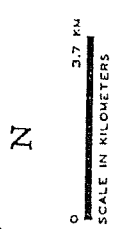
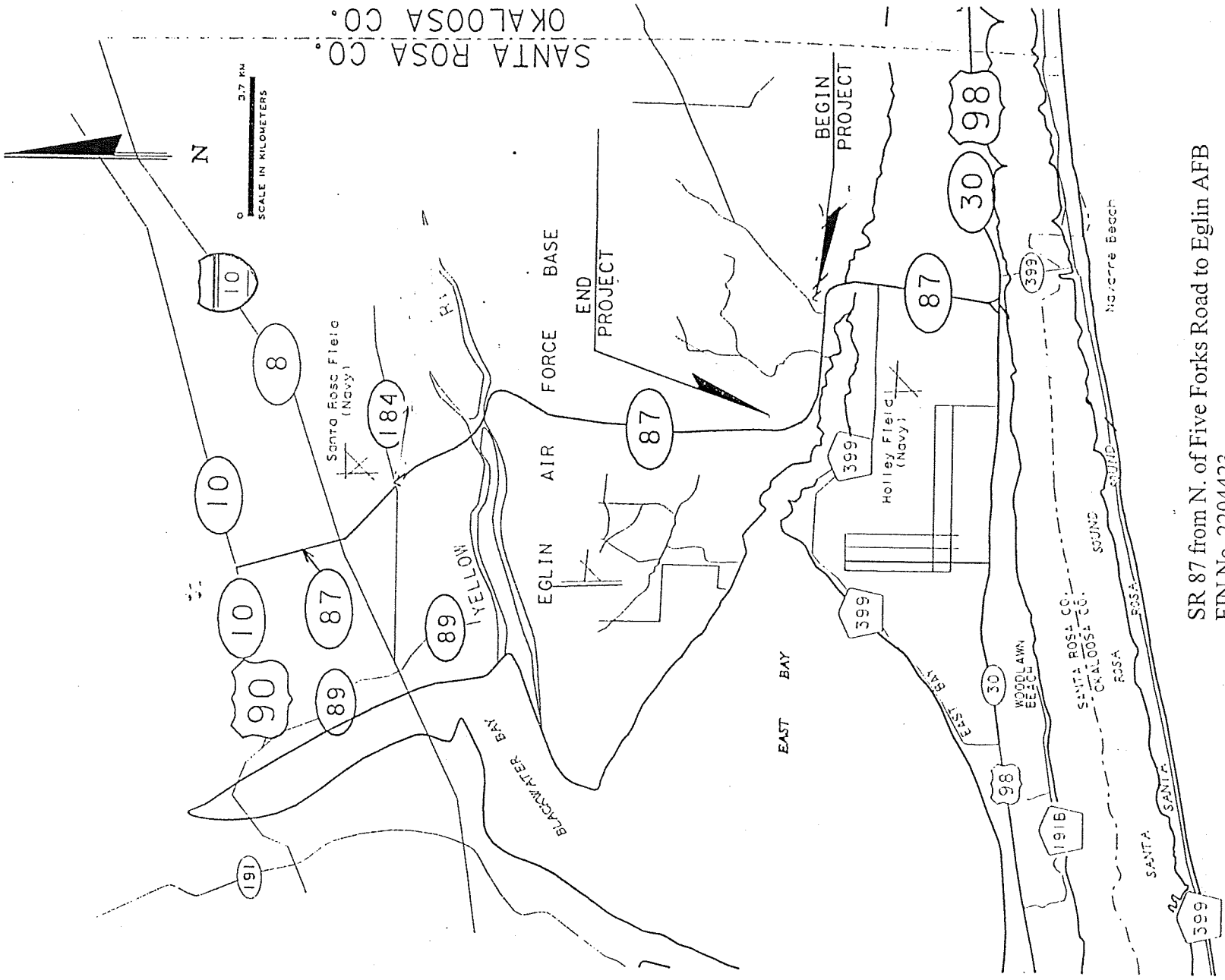

SR 87 from N. of Five Forks Road to Eglin AFB
 FIN No. 2204423
 Section: 5,6,39
 Range: 26W
 Township: 2S



VICINITY MAP



30°05'

END CONSTRUCTION
STA. 72+07.68

30°05'

TO MEDART

R 3 W

R 2 W

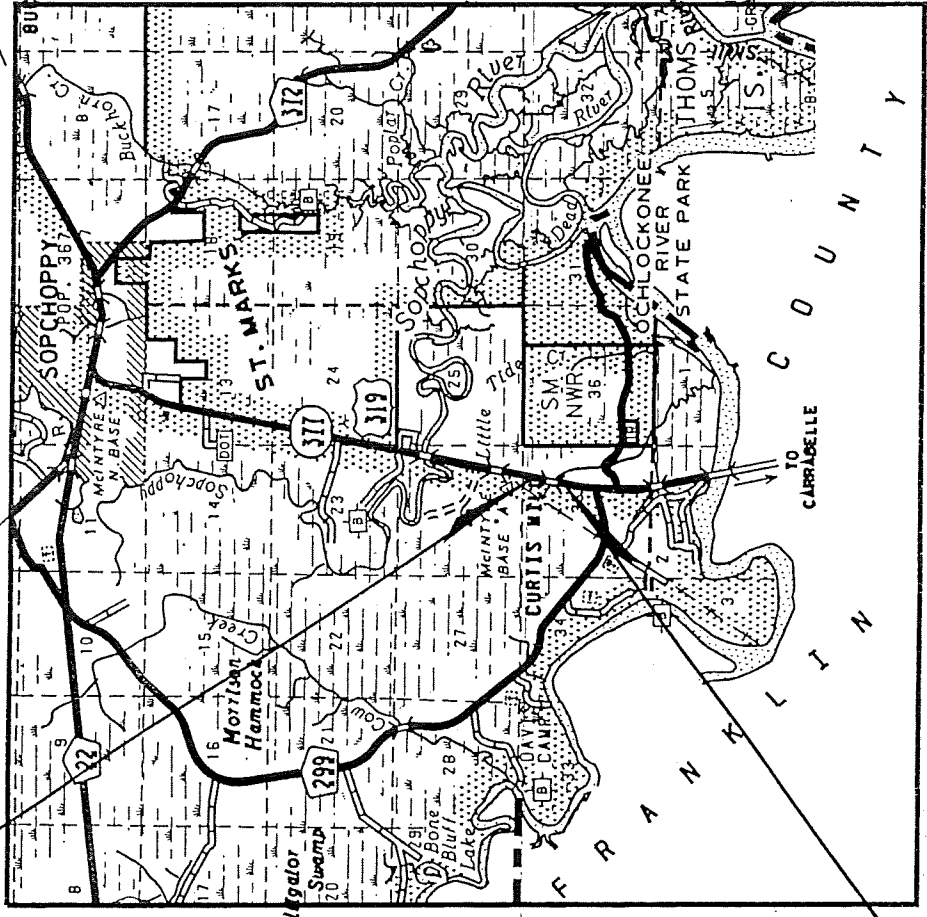

1 5 5

1 5 5

30°00'

BEGIN CONSTRUCTION
STA. 62+35.66

30°00'

1 5 1

1 5 1

R 3 W R 2 E R 2 W

US 319 (CR 377) @ Curtis Mill Creek
FIN 2205061
Section: 35
Range: 3W
Township: 5S

84°35'

VICINITY MAP

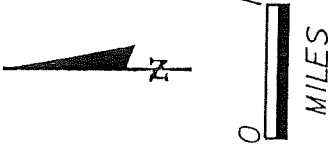

30°05'

30°05'

END CONSTRUCTION
STA. 95+73.66

TO SR 20

TO MEDART

R 3 W R 2 W

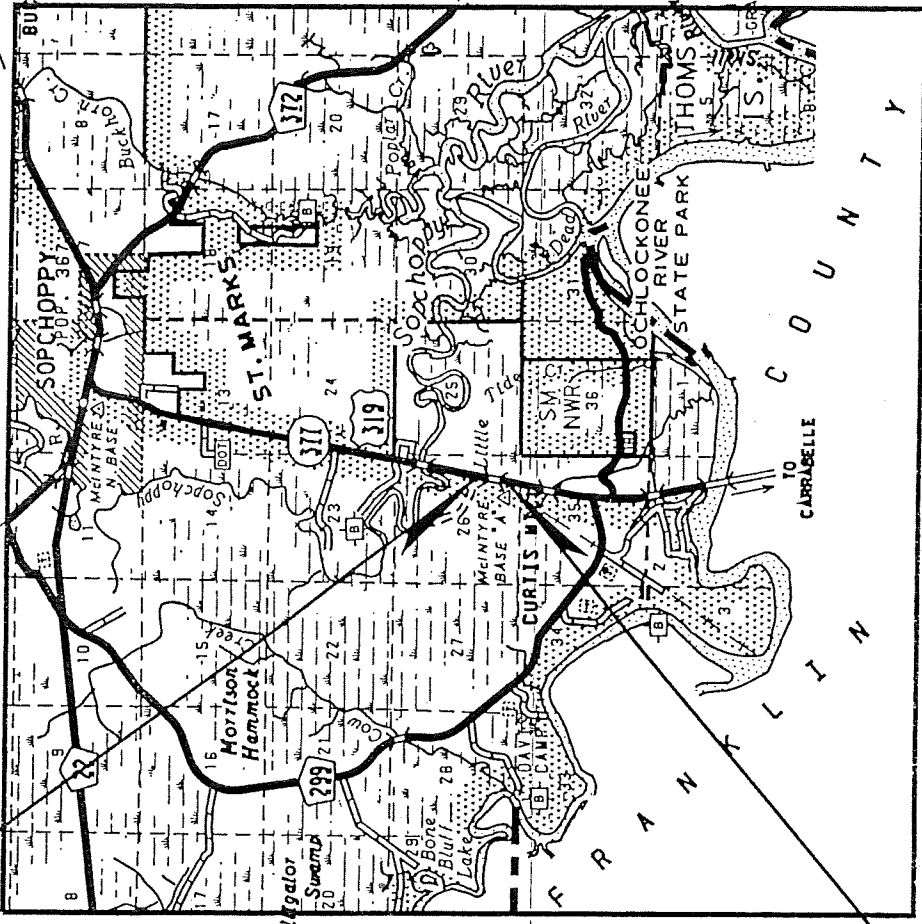

SS

SS

SS 1

TO OCKLOCKNEE BAY

30°00'

+

SS 1

30°00'

+

SS 1

BEGIN CONSTRUCTION
STA. 85+71.48

R 3 W R 2 W

+

R 3 W R 2 W

84°35'

US 319 (CR 377) @ Little Tide Creek
FIN 2205071
Section 26
Range 3W
Township 5S

VICINITY MAP

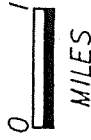

END CONSTRUCTION
STA. 36+75.00

TO BLOXHAM

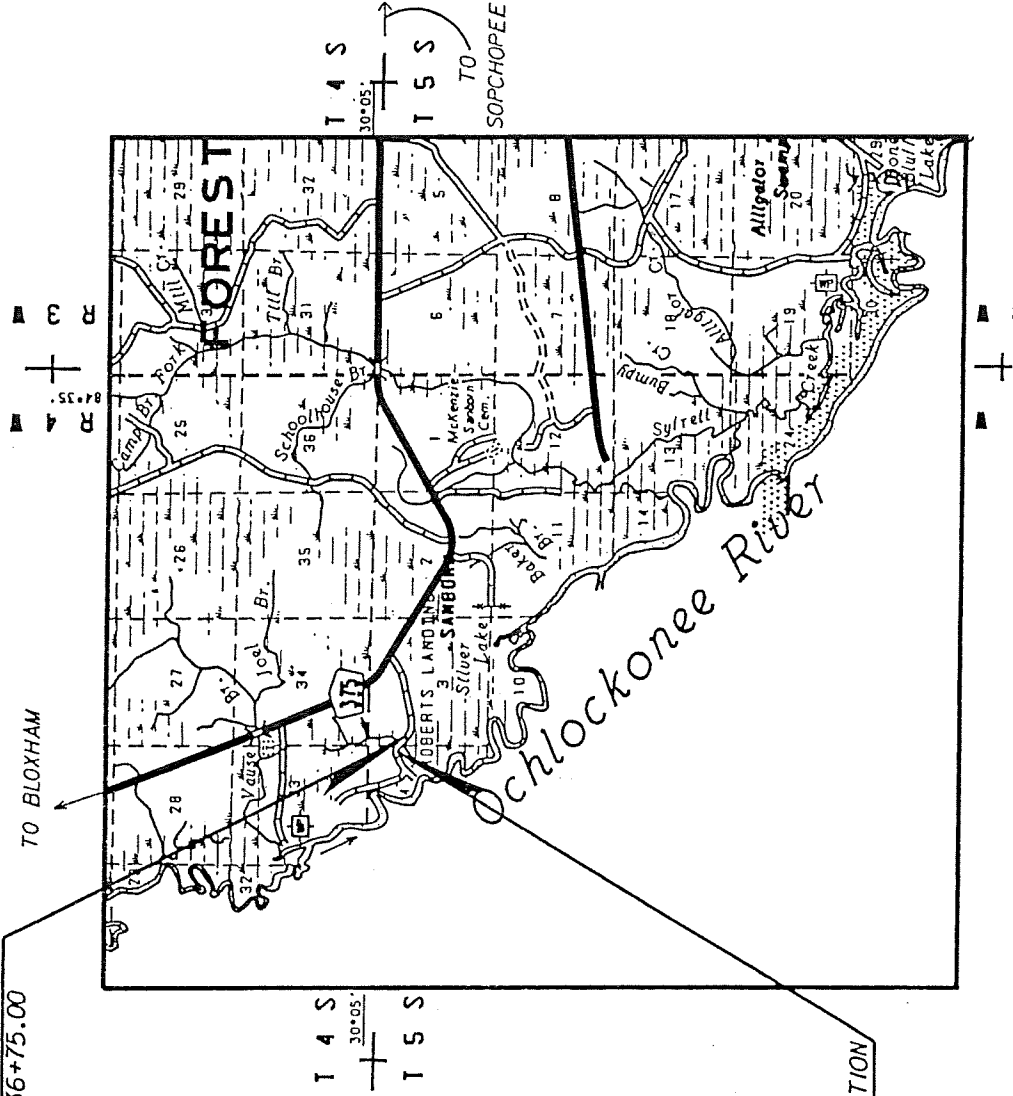

BEGIN CONSTRUCTION
STA. 33+72.66

Roberts Landing Road @ Silver Lake Creek
FIN 4062261
Section 3
Range 4W
Township 5S

STATE OF FLORIDA
DEPARTMENT OF TRANSPORTATION
CONTRACT PLANS

FINANCIAL PROJECT ID. 407304-1-52-01
BRIDGE NOS. 500097 LT., 500098 RT.
S.R. 8 (I-10) OVER LITTLE RIVER & CSX R.R.
GADSDEN COUNTY (50001) - DISTRICT CONTRACT

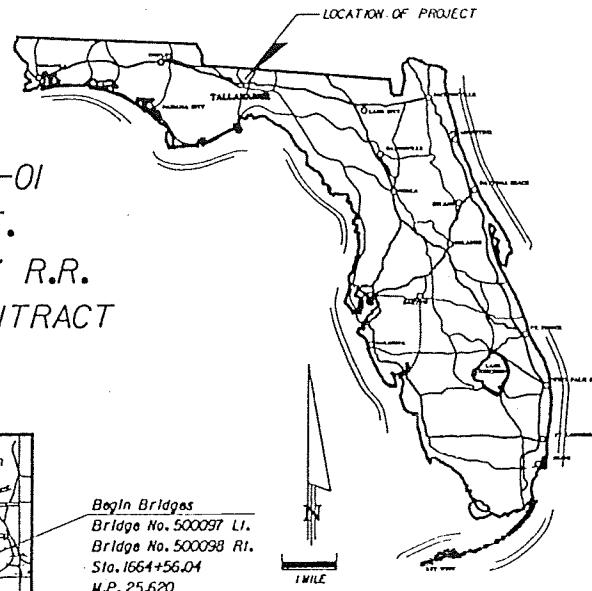

INDEX OF BRIDGE PLANS

SHEET NO.	SHEET DESCRIPTION
B-1	KEY SHEET
B-2	SUMMARY OF PAY ITEMS
B-3	GENERAL NOTES
B-4, B-5	PLAN AND ELEVATION
B-6	PILE LAYOUT
B-7	PILE INSTALLATION TABLE
B-8	CRUTCH BENT DETAILS
B-9	FRAMING PLAN
B-10	STEEL BEAM DETAILS
B-11	COMPOSITE NEOPRENE BEARING PADS
B-12	TOWER BENT ARMORING
B-13	TRAFFIC CONTROL
B-14	WETLAND DELINEATION
B-15	GEOTECHNICAL NOTES
B-16	REPORT OF CORE BORINGS

INDEX OF EXISTING BRIDGE PLANS

SHEET NO.	SHEET DESCRIPTION
EB-1	GENERAL PLAN AND ELEVATION
EB-2	BRIDGE DESIGN DATA SHEET
EB-3	PRESTRESSED CONCRETE PILES
EB-4, EB-5	PILE LAYOUT
EB-6	BORING DATA
EB-7 to EB-11	PILE BENT DETAILS

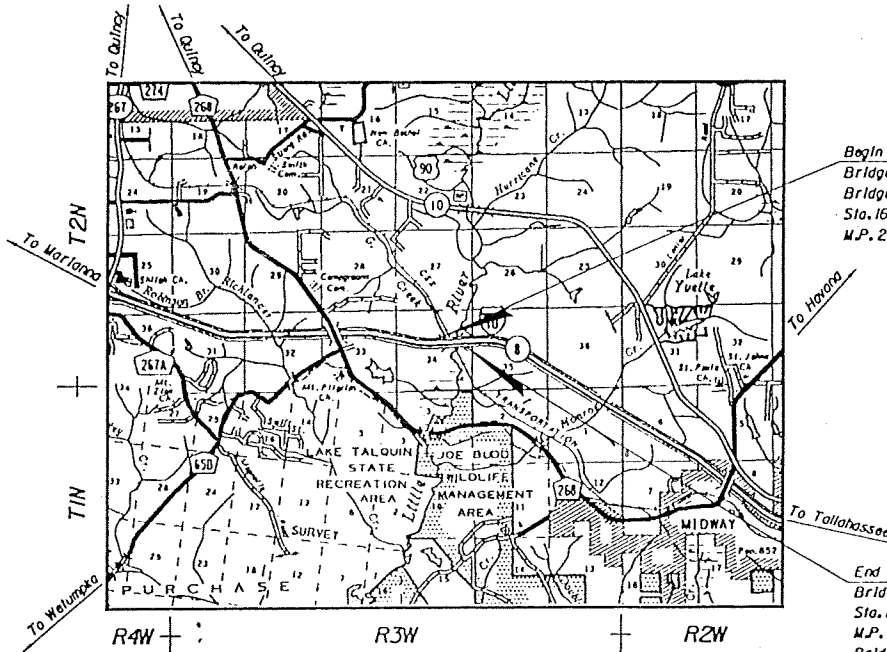

Begin Bridges
Bridge No. 500097 Lt.
Bridge No. 500098 Rt.
Sta. 1664+56.04
M.P. 25.620

End Bridges
Bridge No. 500097 Lt.
Sta. 1675+23.97
M.P. 25.822
Bridge No. 500098 Rt.
Sta. 1674+87.02 Rt.
M.P. 25.815

SHOP DRAWINGS TO BE SUBMITTED TO:

CHARLES F. CRAYCRAFT
FL. P.E. NO. 32131
H.W. LOCHNER, INC.
SUITE 600, 13577 FEATHER SOUND DR.
CLEARWATER, FL. 33762
TELEPHONE: (727) 572-7111
VENDOR NUMBER VF 362338811001

PLANS PREPARED BY:

H.W. LOCHNER, INC.
SUITE 600, 13577 FEATHER SOUND DR.
CLEARWATER, FL. 33762
TELEPHONE: (727) 572-7111
CONTRACT NUMBER C-7376
VENDOR NUMBER VF 362338811001
FBPR CERTIFICATE OF AUTHORIZATION #894

NOTE: THE SCALE OF THESE PLANS MAY HAVE CHANGED BY REPRODUCTION.

GOVERNING STANDARDS AND SPECIFICATIONS: FLORIDA DEPARTMENT OF TRANSPORTATION DESIGN STANDARDS, DATED JANUARY 2002 AND STANDARD SPECIFICATIONS FOR ROAD AND BRIDGE CONSTRUCTION, DATED 2000, AS AMENDED BY CONTRACT DOCUMENTS.

REVISIONS:

LENGTH OF PROJECT		
	LINEAR FT.	MILES
ROADWAY	0.000	0.000
BRIDGE NO. 500097	1047.932	0.302
BRIDGE NO. 500098	1030.979	0.319
NET LENGTH OF PROJ.	2078.911	0.397
EXCEPTIONS	0.000	0.000
GROSS LENGTH OF PROJ.	2078.908	0.397

KEY SHEET REVISIONS	
DATE	DESCRIPTION

Charles F. Craycraft
3/25/03

BRIDGE REHABILITATION PLANS

ENGINEER OF RECORD: _____

DATE: _____
P.E. NO.: 32131

FISCAL YEAR	SHEET NO.
03	B-1

FDOT PROJECT MANAGER: LISA SLAY

SR 8 (I-10) Over Little River & CSX RR
FIN 4073041
Section: 34
Range: 2-N
Township: 3-W
0.44 Acres Mitigation

FDOT District 3 ENVIRONMENTAL IMPACT INVENTORY - FY __ 2003/2004

Work Program Item Number/Fincial Management Number	Project Description	Water Management District	Wetland Location (Include Sec., Rnge., Twtnship)	Name of Drainage Basin	Mitigation Date	Begin Construction Date	Florida Land Use Classification Codes (List Each Wetland Type Separately)	Impact Acres Per Each FLUCCS Type	Wetland Quality	Water Use Classification	Name of Surface Waters or Wetlands	State/Regional Designation(s)	Listed Species Affected Y/N	Permit Application Date
3119143 FIN 2206631	SR 83 (US 331) N. from .5 Mile South of SR 20 to Owl's Head Road	NWFWMD	Sect.10,3,34,35 26 R-19W T-1S & 1N	Choctaw Bay	2003/2004	07/21/2005	411 Pine Flatwoods 615 Stream & Lake Swamp	9.4	Med.	Class 3	Lafayette Creek		No	07/15/2003

Jun-01-00 08:18A JAMES D. BUSH

P.02

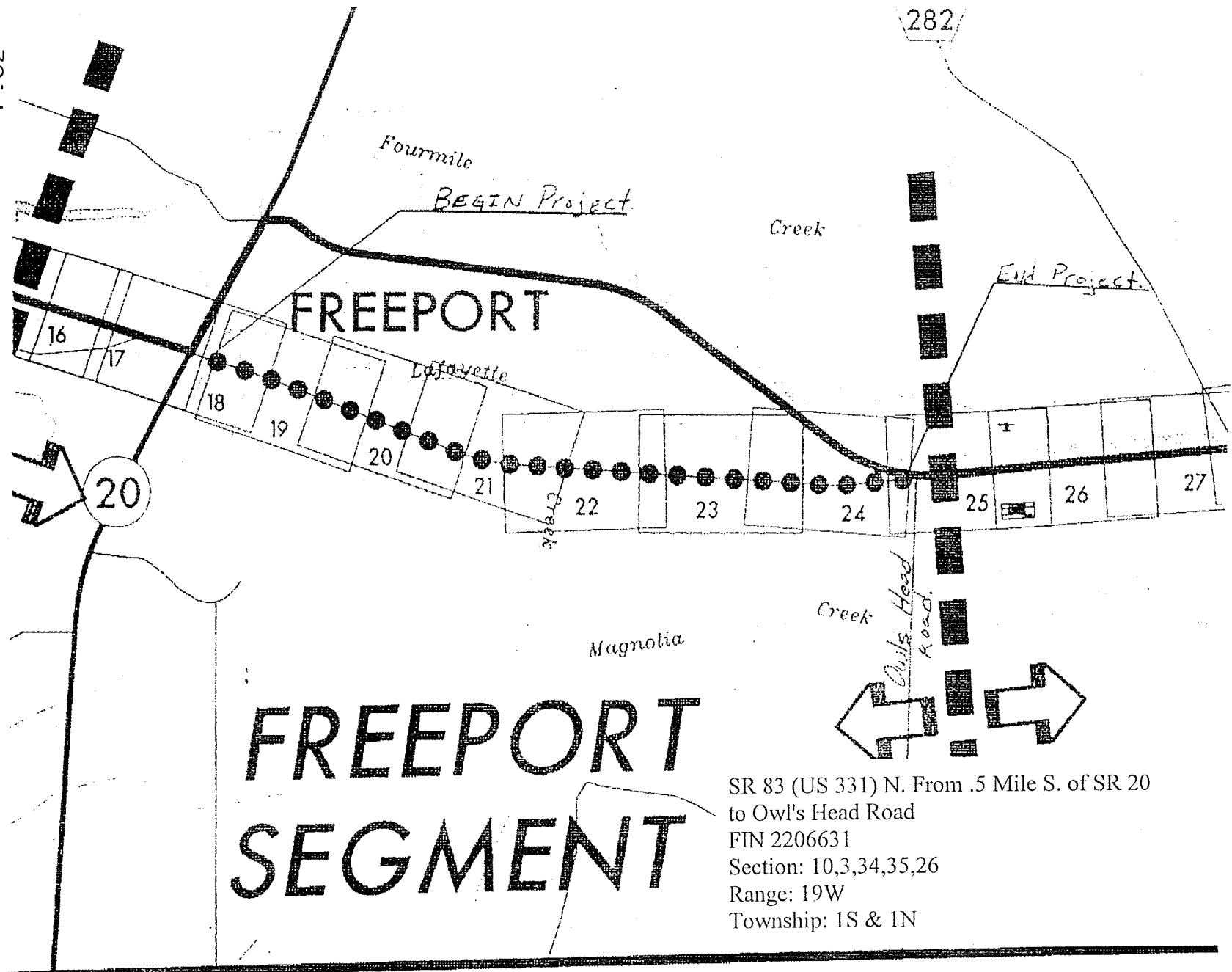

FREEPORT SEGMENT

SR 83 (US 331) N. From .5 Mile S. of SR 20
 to Owl's Head Road
 FIN 2206631
 Section: 10,3,34,35,26
 Range: 19W
 Township: 1S & 1N